

Chain Conveyor Outline 5200

Lenze Smart Products

CCO-5200



Solved with

- Bevel gearbox g500-B600
- Three-phase AC motors m550-P100M4
- Inverter Drives 8400 motec 4.0 kW

Characteristics

Application parameters		Construction data	
Maximum payload	5,200 kg	Chain acc. to DIN8187, ISO 606	10B-2
Cycle time	Up to 300 units/h	Effective circular diameter of chain pinion	91.42 mm (18 teeth)
Max. acceleration	0.5 m/s ²	Reduction gearing	1 : 1
Conveyor speed range (setting values)	0.11 – 0.5m/s (19.2 – 92%)	Hollow shaft diameter	40 H7
Conveyor speed (setting values)	0.5 m/s (92%)	Shaft-hub joint	Featherkey (12 ⁵⁹)
Number of chain strands	2 or 3 strands	Diameter of torque plate bore hole	20 mm
		Mounting position	universal
		Weight of the drive	54 kg

General ambient conditions		Electromechanical properties of the drive solution	
Temperature ranges	0 – 40 °C	El. connection system	<ul style="list-style-type: none"> • 3 x 400V up to 480V (via QuickOn) • 2 x M12 (4pol, A-coded, plug)
Approvals	CE, UL, CSA, EAC, CCC	• Power (type)	
Degree of protection	IP55	• Control signals (type)	
Surface	Aluminium (unpainted)	Brake resistor	integrated
		Electromechanical brake	none

Chain Conveyor Outline 5200

Lenze Smart Products



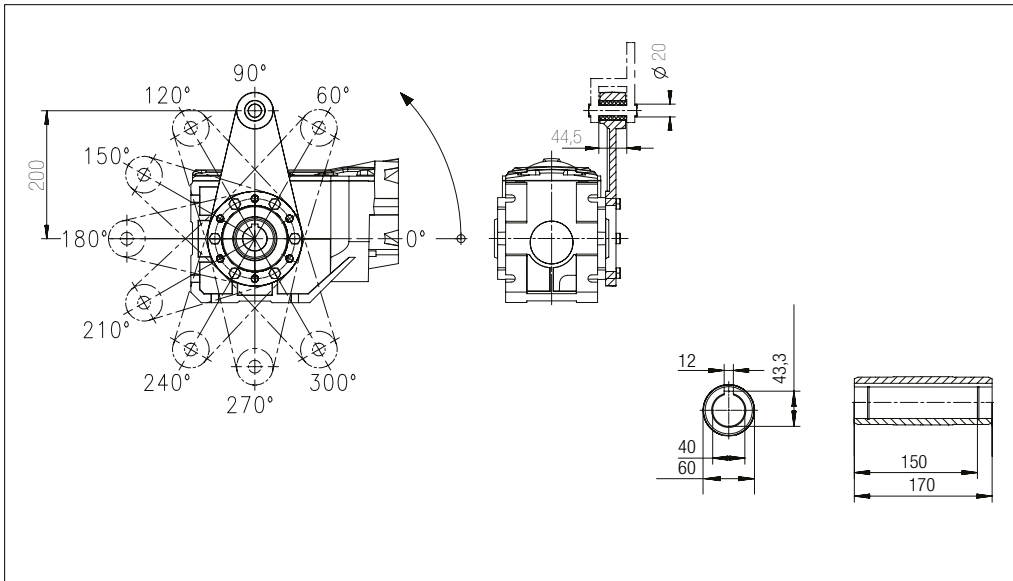

Fixing dimensions

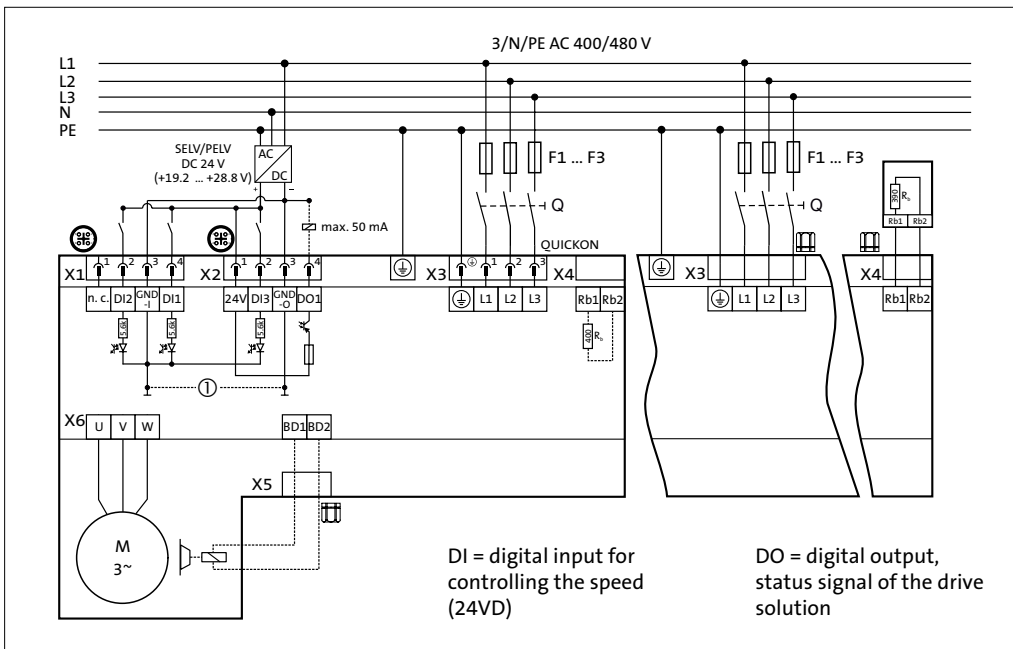

Electrical connection plan



More details

CAD file	E-Plan Makro	Design basis	Mounting instructions	PC connection Easy Starter
 CAD	 E-Plan Makro	 Design basis	 MI	