

# Chain Conveyor Outline 4000

Lenze Smart Products

# CCO-4000



## Solved with

- Bevel gearbox g500-B450
- Three-phase AC motors m550-P90L4
- Inverter Drives 8400 motec 3.0 kW

## Characteristics

Application parameters		Construction data	
Maximum payload	4,000 kg	Chain acc. to DIN8187, ISO 606	10B-2
Cycle time	Up to 300 units/h	Effective circular diameter of chain pinion	91.42 mm (18 teeth)
Max. acceleration	0.5 m/s <sup>2</sup>	Reduction gearing	1 : 1
Conveyor speed range (setting values)	0.11 – 0.5m/s (19.2 – 91.7%)	Hollow shaft diameter	35 H7
Conveyor speed (setting values)	0.5 m/s (91.7%)	Shaft-hub joint	Featherkey (10 <sup>5/9</sup> )
Number of chain strands	2 or 3 strands	Diameter of torque plate bore hole	20 mm
		Mounting position	universal
		Weight of the drive	38 kg

General ambient conditions		Electromechanical properties of the drive solution	
Temperature ranges	0 – 40 °C	El. connection system • Power (type) • Control signals (type)	• 3 x 400V up to 480V (via QuickOn) • 2 x M12 (4pol, A-coded, plug)
Approvals	CE, UL, CSA, EAC, CCC	Brake resistor	integrated
Degree of protection	IP55	Electromechanical brake	none
Surface	Aluminium (unpainted)		

# Chain Conveyor Outline 4000

Lenze Smart Products



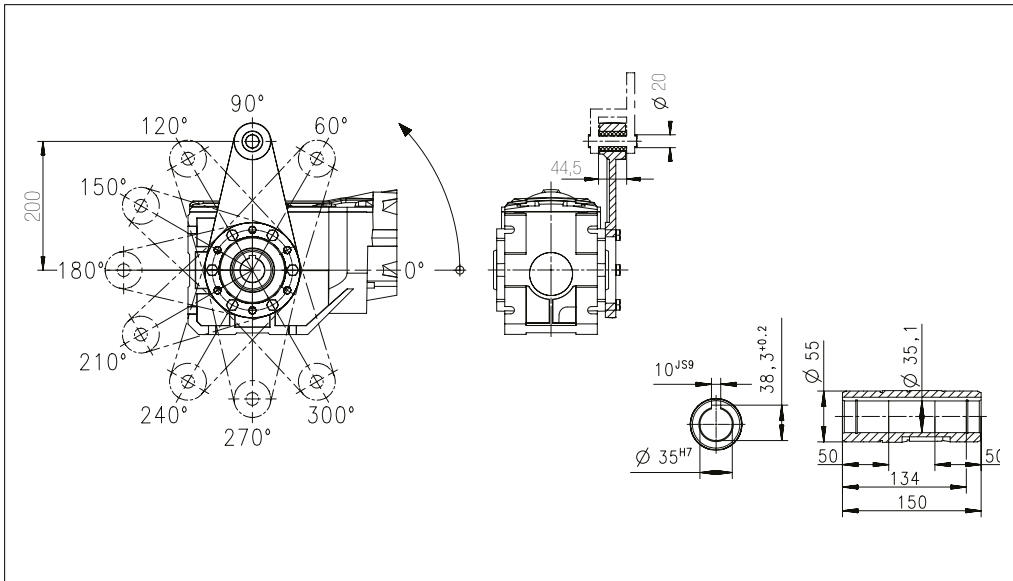

## Fixing dimensions

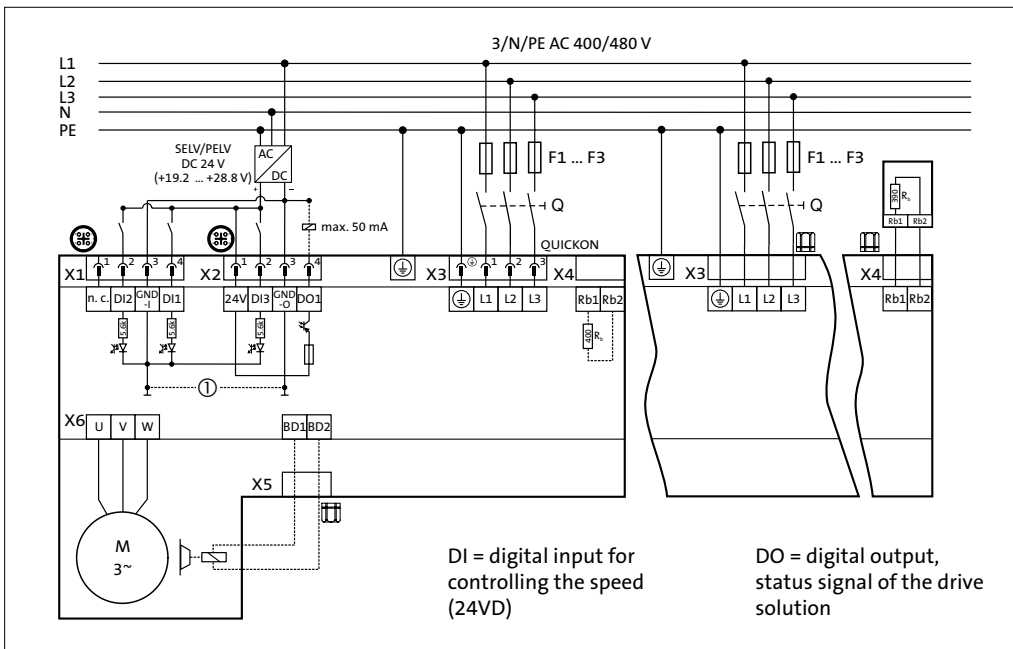

## Electrical connection plan



## More details

CAD file	E-Plan Makro	Design basis	Mounting instructions	PC connection Easy Starter
 <b>CAD</b>	 E-Plan Makro	 Design basis	 <b>MA</b>	