

# Chain Conveyor Outline 5200

Lenze Smart Products

# CCO-5200



## Solved with

- Bevel gearbox g500-B600
- Three-phase AC motors m550-P100M4
- Inverter Drives 8400 motec 4.0 kW

## Characteristics

Application parameters		Construction data	
Maximum payload	5,200 kg	Chain acc. to DIN8187, ISO 606	10B-2
Cycle time	Up to 300 units/h	Effective circular diameter of chain pinion	91.42 mm (18 teeth)
Max. acceleration	0.5 m/s <sup>2</sup>	Reduction gearing	1 : 1
Conveyor speed range (setting values)	0.11 – 0.5m/s (19.2 – 92%)	Hollow shaft diameter	40 H7
Conveyor speed (setting values)	0.5 m/s (92%)	Shaft-hub joint	Featherkey (12 <sup>59</sup> )
Number of chain strands	2 or 3 strands	Diameter of torque plate bore hole	20 mm
		Mounting position	universal
		Weight of the drive	54 kg

General ambient conditions		Electromechanical properties of the drive solution	
Temperature ranges	0 – 40 °C	El. connection system	<ul style="list-style-type: none"> <li>• 3 x 400V up to 480V (via QuickOn)</li> <li>• 2 x M12 (4pol, A-coded, plug)</li> </ul>
		<ul style="list-style-type: none"> <li>• Power (type)</li> <li>• Control signals (type)</li> </ul>	
Approvals	CE, UL, CSA, EAC, CCC	Brake resistor	integrated
Degree of protection	IP55	Electromechanical brake	none
Surface	Aluminium (unpainted)		

# Chain Conveyor Outline 5200

Lenze Smart Products

## Fixing dimensions

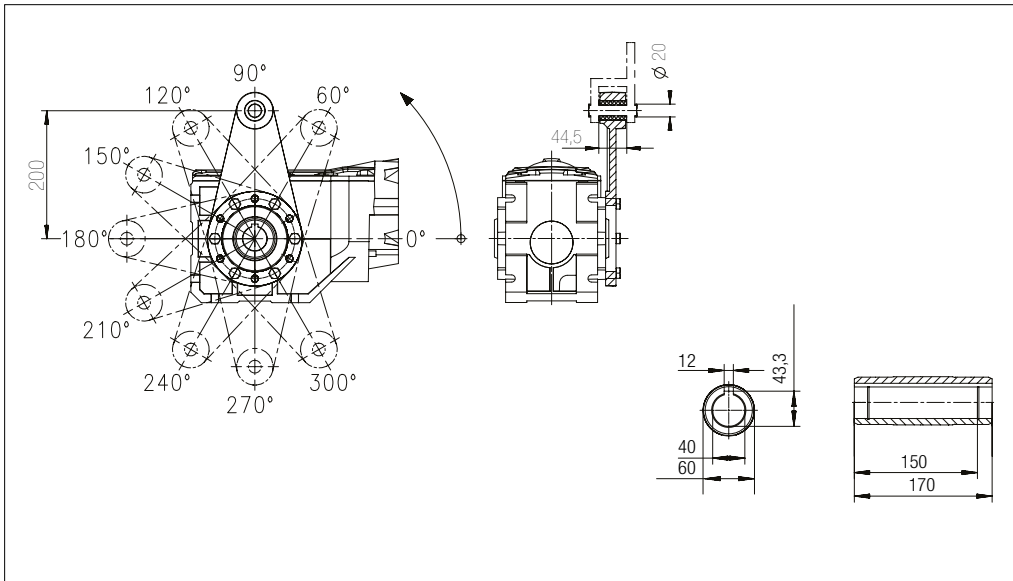

## Electrical connection plan

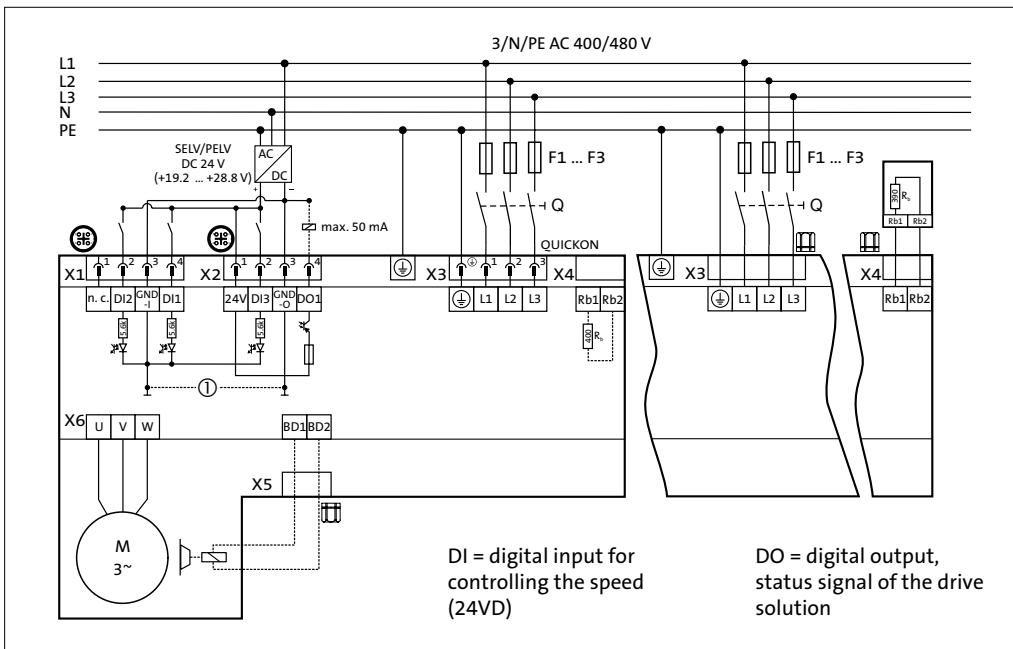

## More details

CAD file	E-Plan Makro	Design basis	Mounting instructions	PC connection Easy Starter
